

INSTALLATION

1. INSTALL DRIVE PLATE

- (a) Apply adhesive to 2 or 3 threads of the bolt end.

Adhesive:

**Part No. 08833-00070, THREE BOND 1324
or equivalent**

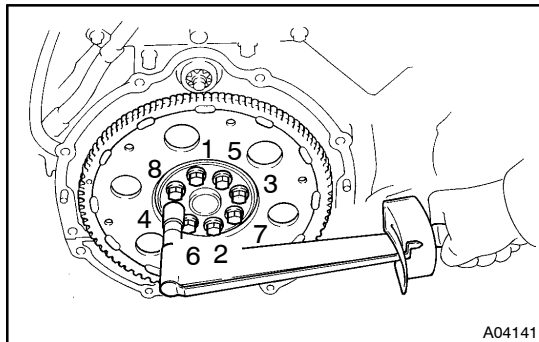

- (b) Install the front spacer, drive plate and rear plate on the crankshaft.
(c) Install and uniformly tighten the 8 bolts in several passes, in the sequence shown.

Torque: 98 N·m (1,000 kgf·cm, 72 ft·lbf)

2. INSTALL TRANSMISSION TO ENGINE

(See page AT-25)

3. INSTALL OIL COOLER PIPE FOR TRANSMISSION

- (a) Temporarily install the oil cooler pipe with the 2 pipe brackets and 2 bolts.
(b) Connect the 2 oil cooler pipes to the unions on the transmission.

Torque: 34 N·m (350 kgf·cm, 25 ft·lbf)

- (c) Tighten the 2 pipe clamp bolts.

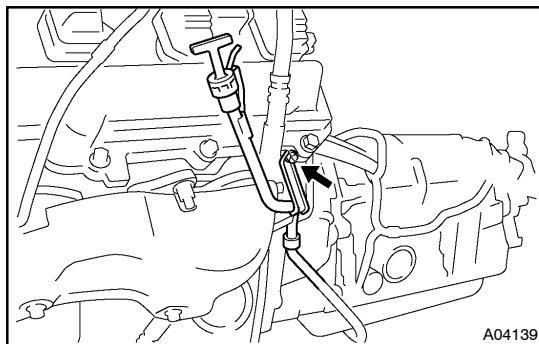

4. INSTALL OIL DIPSTICK GUIDE AND DIPSTICK FOR TRANSMISSION

- (a) Install a new O-ring to the dipstick guide.
(b) Apply soapy water to the O-ring.
(c) Connect the dipstick guide end to the dipstick tube of the oil pan.
(d) Install the dipstick guide with the bolt.
(e) Install the dipstick.

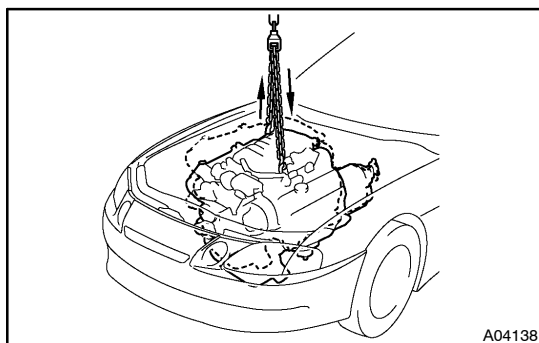

5. INSTALL ENGINE AND TRANSMISSION ASSEMBLY IN VEHICLE

- (a) Attach the engine chain hoist to the engine hangers.
(b) Slowly lower the engine and transmission assembly into the engine compartment.

NOTICE:

Be careful not to hit the PS gear housing and PNP switch.

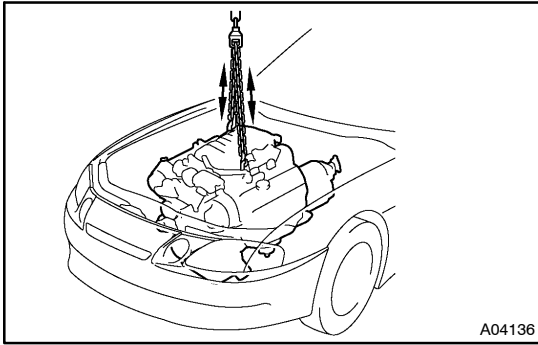

- (c) Insert the stud bolts of the front engine mounting brackets into the stud bolt holes of the front suspension crossmember.
- (d) Keep the engine level.
- (e) Install the rear engine mounting member with the 4 bolts and 4 nuts.

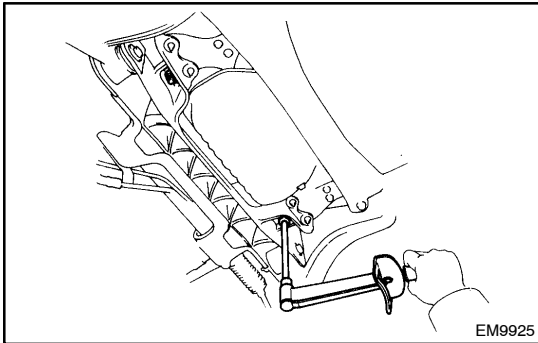
Torque:**Bolt: 25 N·m (250 kgf·cm, 19 ft·lbf)****Nut: 13 N·m (135 kgf·cm, 10 ft·lbf)**

- (f) Install the 2 nuts holding the engine mounting brackets to the front suspension crossmember.

Torque: 59 N·m (600 kgf·cm, 43 ft·lbf)**6. CONNECT TRANSMISSION CONTROL ROD TO SHIFT LEVER**

Connect the control rod to the shift lever with the nut.

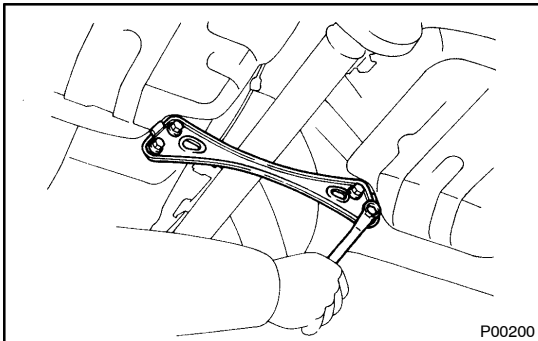
7. INSTALL PROPELLER SHAFT (See page [PR-15](#))**8. INSTALL CENTER FLOOR CROSSMEMBER BRACE**

Install the crossmember brace with the 4 nuts.

Torque: 13 N·m (130 kgf·cm, 9 ft·lbf)**9. INSTALL HEAT INSULATOR FOR FRONT EXHAUST PIPE**

Install the heat insulator with the 4 bolts.

10. INSTALL CENTER EXHAUST PIPE

Install the 2 hooks of the exhaust pipe to the rings on the exhaust pipe brackets.

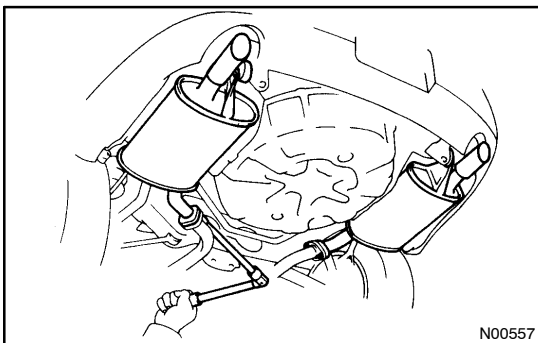
**11. INSTALL TAILPIPE**

- (a) Install the hook of the tailpipe to the ring on the tailpipe bracket.

- (b) Install a new gasket and tailpipe to the center exhaust pipe with 2 bolts. Install the 2 tailpipes.

Torque: 19 N·m (195 kgf·cm, 14 ft·lbf)**12. INSTALL TWC**

Using a 14 mm deep socket wrench, install a new gasket and the TWC with 3 new nuts. Install the 2 TWC.

Torque: 62 N·m (630 kgf·cm, 46 ft·lbf)**13. INSTALL FRONT EXHAUST PIPE**

- (a) Temporarily install the pipe support bracket with the 4 bolts.

- (b) Temporarily install 3 new gaskets and the exhaust pipe with the 6 bolts and nuts.

- (c) Tighten the 4 bolts and nuts holding the TWC to the front exhaust pipe.

Torque: 43 N·m (440 kgf·cm, 32 ft·lbf)

- (d) Tighten the 2 bolts and nuts holding the front exhaust pipe to the center exhaust pipe.

Torque: 43 N·m (440 kgf·cm, 32 ft·lbf)

- (e) Tighten the 4 bolts holding the pipe support bracket to the transmission.

Torque: 43 N·m (440 kgf·cm, 32 ft·lbf)

14. INSTALL HEATED OXYGEN SENSORS (BANK1, 2 SENSOR2)

Install the 2 oxygen sensors to the front exhaust pipe.

Torque: 44 N·m (450 kgf·cm, 33 ft·lbf)

HINT:

- Before installing the oxygen sensor, twist the sensor wire counterclockwise 3 and 1/2 turns.
- After installing the oxygen sensor, check that the sensor wire is not twisted. If it is twisted, remove the oxygen sensor and reinstall it.

15. CONNECT ENGINE WIRE TO CABIN

- (a) Push in the engine wire through the cowl panel.

NOTICE:

Be careful not to damage the engine wire. Tape the engine wire.

- (b) Install the engine wire retainer with the 2 bolts.
- (c) Connect these connectors:
- (1) 6 connectors to ECM
 - (2) 4 connectors to connector cassette
 - (3) Connector to A/C control assembly
- (d) Install the ECM with the 2 nuts.
- (e) Install the ECM protector with the 2 nuts.
- (f) Install the floor carpet.
- (g) Install the scuff plate.
- (h) Connect the connectors.
- (i) Install the lower instrument panel finish panel and glove compartment door assembly with the 4 screws.
- (j) Install the instrument panel under cover with the 2 clips.

16. CONNECT HOSES

Connect these hoses and ground strap:

- (1) Heater water hose to water bypass pipe
- (2) Heater water hose to heater water valve
- (3) Brake booster vacuum hose
- (4) Vacuum hose (from VSV for heater water valve) to intake manifold
- (5) PS air hose
- (6) Ground strap to bracket on body
- (7) EVAP hose from VSV for EVAP
- (8) Fuel hose

SST 09278-54012

Torque: 30 N·m (310 kgf·cm, 22 ft·lbf)

HINT:

Use a torque wrench with a fulcrum length of 30 cm (11.81 in.).

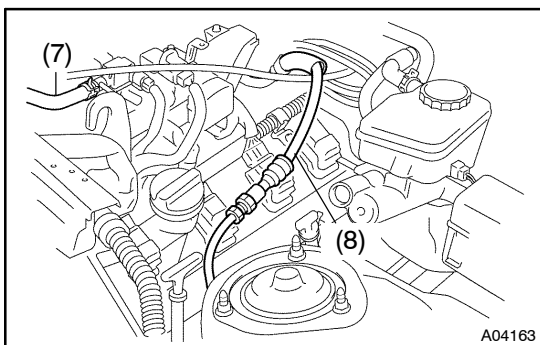
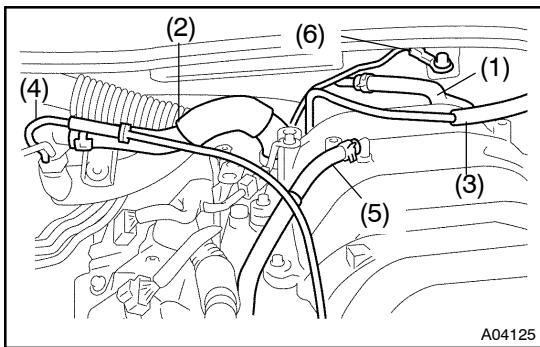

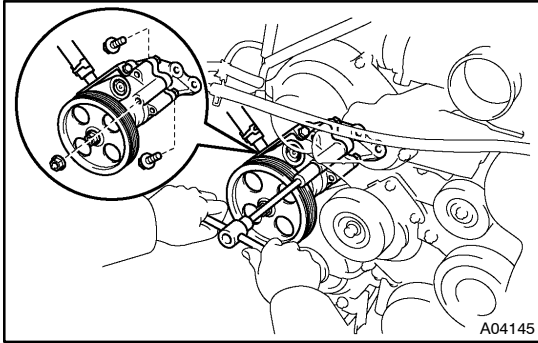

17. **INSTALL AIR CONDITIONING (A/C) COMPRESSOR**
 - (a) Install the A/C compressor with the 2 bolts.
Torque: 49 N·m (500 kgf·cm, 36 ft·lbf)
 - (b) Connect the wire clamp to the A/C compressor
 - (c) Install the A/C compressor stay with the bolt.
Torque: 29 N·m (300 kgf·cm, 22 ft·lbf)
 - (d) Connect the ground cable to the A/C compressor stay with the nut.
 - (e) Connect the A/C compressor connector.
18. **INSTALL GENERATOR**
(See page CH-17)
19. **INSTALL POWER STEERING (PS) PUMP TO ENGINE**
 - (a) Install the PS pump with the nut and 2 bolts. Alternately tighten the bolts and nut.
Torque:
Bolt: 39 N·m (400 kgf·cm, 29 ft·lbf)
Nut: 43 N·m (440 kgf·cm, 32 ft·lbf)
20. **INSTALL POWER STEERING (PS) RESERVOIR TANK AND BRACKET TO BODY**
21. **INSTALL POWER STEERING (PS) TUBES TO SUSPENSION CROSSMEMBER**
22. **INSTALL POWER STEERING (PS) SOLENOID VALVE CONNECTOR**
23. **INSTALL GROUND CABLE TO BODY**
24. **CONNECT THEFT DETERRENT HORN CONNECTOR**
25. **CONNECT ENGINE WIRE CONNECTORS**
26. **INSTALL RADIATOR ASSEMBLY AND RESERVOIR TANK**
(See page CO-53)
27. **INSTALL AIR CLEANER AND INTAKE AIR CONNECTOR ASSEMBLY**
28. **CONNECT ACCELERATOR CABLE**
29. **INSTALL DRIVE BELT**
(See page CH-17)
30. **FILL WITH ENGINE COOLANT**
31. **FILL WITH ENGINE OIL**
32. **INSTALL V-BANK COVER AND BATTERY**
33. **START ENGINE AND CHECK FOR LEAKS**
34. **CHECK TRANSMISSION FLUID LEVEL**
35. **DO ENGINE ADJUSTMENT**
36. **INSTALL ENGINE UNDER COVERS**
37. **INSTALL HOOD**
38. **DO ROAD TEST**
Check for abnormal noises, shock slippage, correct shift points and smooth operation.
39. **RECHECK ENGINE COOLANT AND OIL LEVELS**